

# Combination Foot Rail Bracket

1.5" OD

Combination brackets are our most popular style of bar rail bracket because of their classic look and ease of installation. The weight on the bracket is distributed between the bar face and floor to provide support.



Mounts to bar face with the two included screws.



Does not require drilling into floor or access to back of bar.



Secures tubing 6" off the floor and 6-7" away from bar face.

## Standard Finishes



Brushed Brass



Polished Brass



Brushed Stainless



Matte Black



Oil Rubbed Bronze

*Custom finishing is available upon request.*

## Dimensions

(H)	Height	6.00"
(W)	Width	7.00"
(D)	Diameter	1.50"
(CP <sub>1</sub> )	Center Point 1	6.13"
(CP <sub>2</sub> )	Center Point 2	5.25"

## Included Hardware

(2)	#10 1-1/2" Mounting Screws
(1)	#8 3/4" Self-Drilling Set Screw

## Installation

1. Measure & mark holes for mounting screws.
2. Attach brackets to the face of the bar with mounting screws.
3. Secure tubing to bracket by fastening set screws through hole in the bottom of bracket.

Care and maintenance varies by finish. Given the nature of the product, typical wear and tear may be noticed with your bar rail over time, such as scuffs, scratches, and dirt.

Visit [Kegworks.com/care-guide](https://www.kegworks.com/care-guide) to read our guide on how to properly prep, clean, and maintain all bar rail finishes.

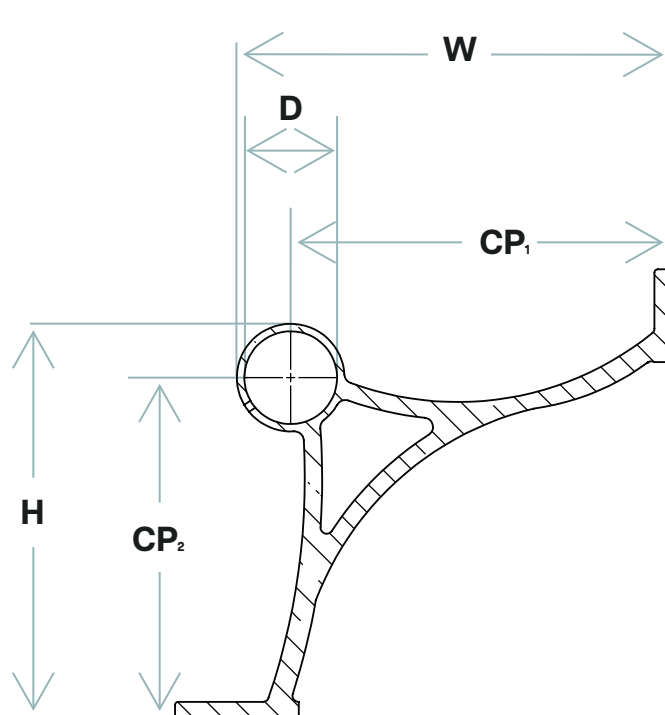

## Complete The System

Make sure to get all the necessary components to complete your bar rail system.

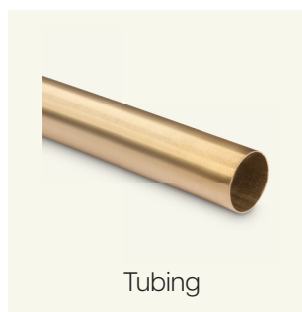

Tubing



End Caps

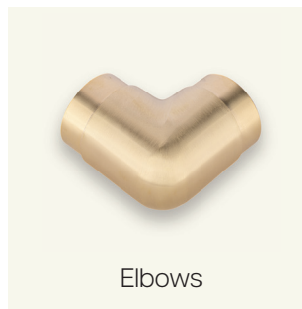

Elbows

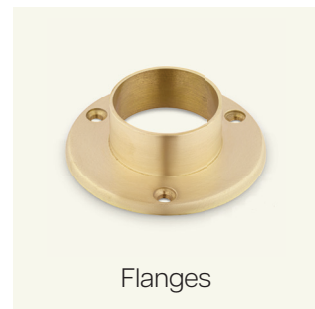

Flanges