

Bar Mount Foot Rail Bracket

1.5" OD

Bar mount brackets are a great option for those that can't (or don't want) to drill holes into their floors, and keep it clear of mounts that can stub toes.



Must have access to back of bar face to install 2 3/4" hanger bolt.



Classic look and ease of installation.



Allows you to install bar rail higher than standard 6" height.

Standard Finishes



Brushed Brass



Polished Brass



Brushed Stainless



Matte Black



Oil Rubbed Bronze

Custom finishing is available upon request.

Dimensions

(H)	Height	6.00"
(W)	Width	7.00"
(D)	Diameter	1.52"
(CP ₁)	Center Point 1	6.25"
(CP ₂)	Center Point 2	5.15"

Included Hardware

(3)	#10 1-1/2" Mounting Screws
(1)	5/16"-18 x 3" Threaded Bolt
(1)	5/16"-18 Hex Nut
(1)	5/16" Flat Washer
(1)	#8 3/4" Self-Drilling Set Screw

Installation

1. Measure & mark holes for mounting screws and for the threaded bolt.
2. Drill hole in bar diewall for the threaded rod.
3. Attach bracket from behind bar face using rod and secure with bolt and washer.
4. Attach brackets to the face of the bar with the 3 mounting screws.
5. Secure tubing to bracket by fastening set screws through hole in the bottom of bracket.

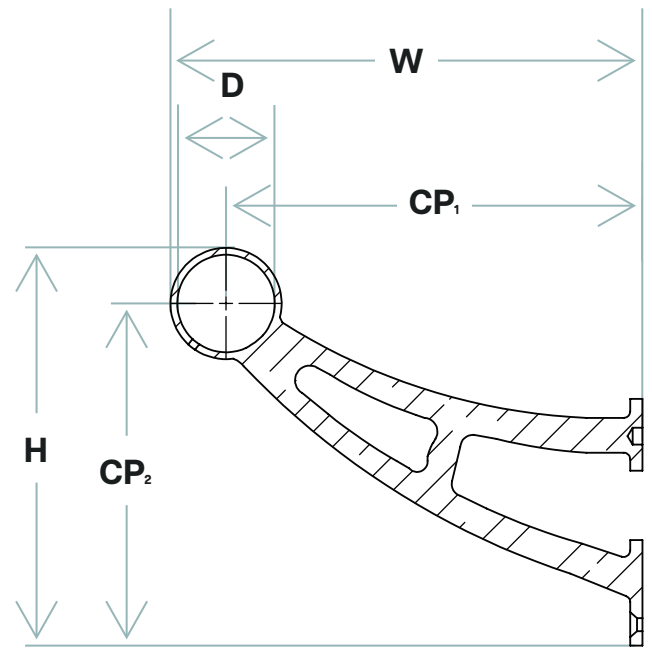

Complete The System

Make sure to get all the necessary components to complete your bar rail system.

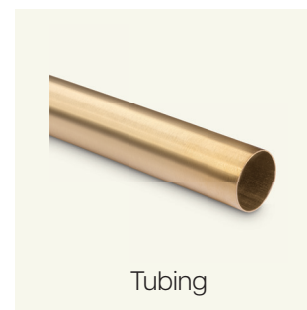

Tubing



End Caps

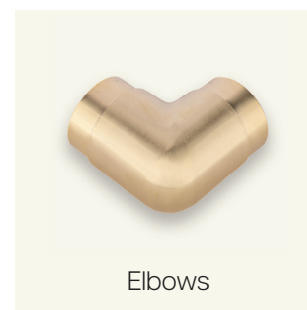

Elbows

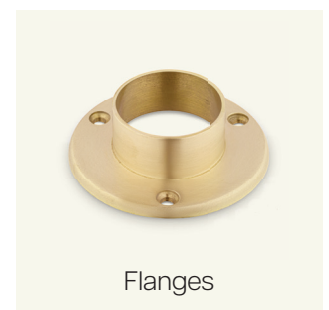

Flanges

Visit **[Kegworks.com/care-guide](https://www.kegworks.com/care-guide)** to read our guide on how to properly prep, clean, and maintain all bar rail finishes.